



FELT ELECTRIC



SPORTe / QXe
FENDERS, RACK & LIGHTING
INSTALLATION MANUAL



Thank you for purchasing a Felt Electric. As with all of our bikes and accessories, our aim is to provide the rider with the best experience possible. This instruction kit is to allow for proper installation of the fenders, rack, and lighting that all make up the SPORTe / QXe City Kit.

THIS INSTALLATION MANUAL IS BROKEN UP INTO TWO PARTS.

PART 1: Step-by-step instructions on installation procedure for the front light and fender for all SPORTe and QXe models.

PART 2: Step-by-step instructions on installation procedure for the rear light, rack, and fender for all SPORTe and QXe models.



PARTS LIST

- Front & Rear Fenders
- Fender Hardware & Brackets
- Rear Rack w/Rear Light
- Rear Rack Struts & Hardware
- Rear Rack Dock
- Rear Reflector / Mudflap
- Front Light



REQUIRED TOOLS

- 8mm Allen Wrench
- 4mm Allen Wrench
- 3mm Allen Wrench
- Torx Allen Set
- CCP-44 Crank Puller
- Snips / Wire Cutters
- 2 x 11mm Wrench
- Flathead Screwdriver
- Pick

PART 1: FRONT LIGHT & FENDER INSTALLATION



1 Start by removing the battery from the bicycle to ensure that the Bosch System is deactivated.

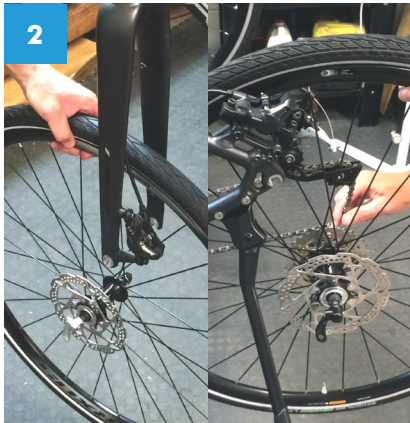

2 Remove the front and rear wheel and set them aside.

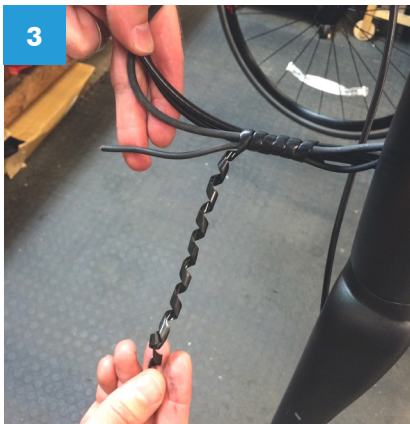

3 Carefully uncoil the front cluster of cables to expose the front light cable.

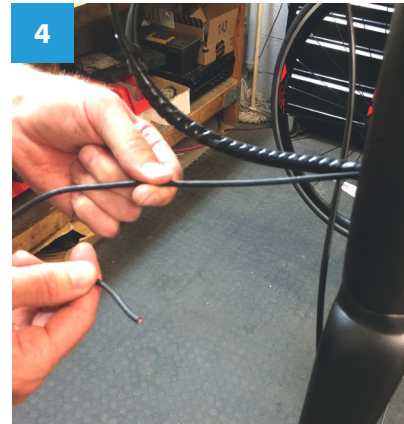

4 Once the front light cable has been separated from the main cable cluster, re-coil the cover back over the main cables.

Carefully pull the front light cable from the frame to gain more length.



5 Locate two cable crimps and two silicone covers for the next step.

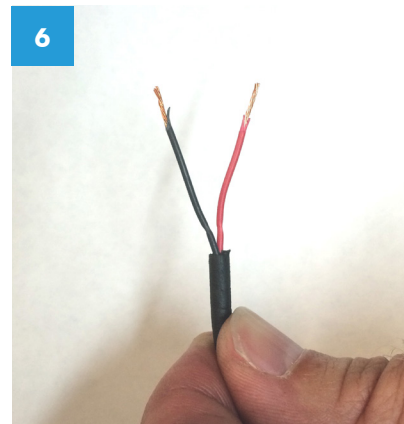

6 Strip each of the wires to allow for enough room for the cable crimps and silicone covers.

7

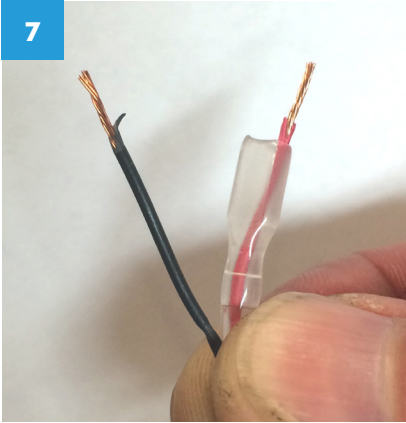

Once each of the cables are stripped, place a silicone cover over one of the wires.

10

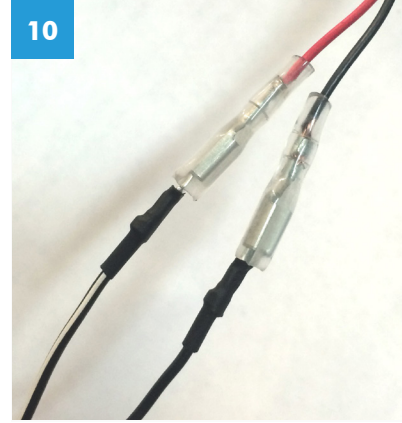

Connect the light wires to the Bosch System and slide the silicone covers over the connections.

8

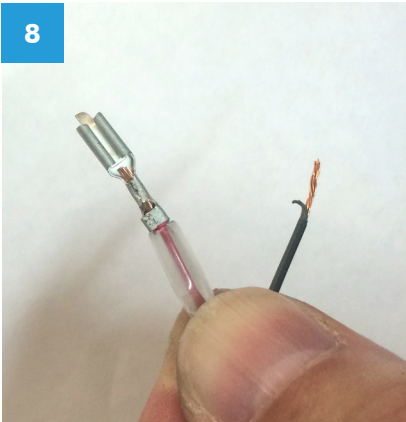

Keep the silicone cover in place while installing the cable crimp.

Once the cable crimp is installed, repeat the same process on the opposing wire.

11



Once each of the wires are connected, tightly wrap the connections in electrical tape to protect them.

9



Loosely install the fender & front light by bolting them into the fork crown. Once in place, gently snug the fastening bolts.

12



Tuck the excess cable back into the frame.

PART 2: REAR LIGHT, FENDER & RACK INSTALLATION



13

Gently snug the front fender bracket to the hole found on the inside of the fork blade. Do not tighten yet because you want to leave room for later adjustment.

Repeat this step for the opposing side.



14

Insert the fender brackets into the mounts on the front fenders. Once in place, gently snug the fender bracket fasteners. Do not tighten yet because you want to leave room for later adjustment.

Repeat this step for the opposing side.



15

Once both brackets are loosely in place, reinstall the front wheel & adjust the front fender until the wheel no longer rubs. Once this is done, secure the fender by tightening each of the fender's fasteners and mounting bolts.



1

Move to the back of the bike and remove the kickstand, and set it aside.



2

By removing the kickstand, you will be exposing the cable for the rear light.

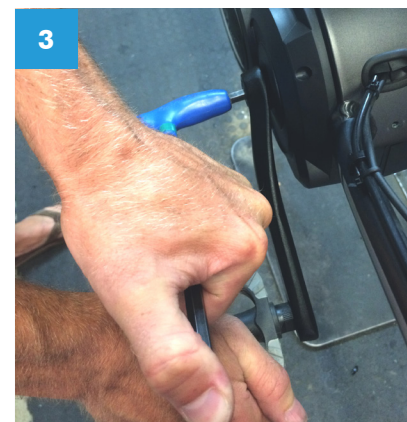

3

Begin removing the left crank arm by unthreading the left lock bolt.

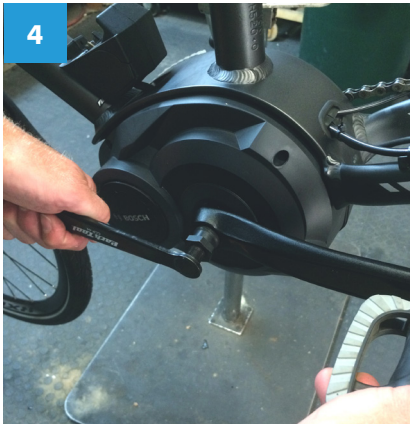

Once the left lock bolt is removed, use a crank arm puller to remove the left crank arm.



Remove each of the 3 torx screws holding the left side of the motor cover in place.



Remove the left side of the motor cover to expose the remainder of the rear light cable. Unbundle the rear light cable.



Grasp the rear light cable and pull the newly unbound cable to the rear end of the bike.

It's important that the cable threads through the opening found in the rear dropout as shown.



Thread the rear light cable through the opening found near the lower mount of the rack (non-drive side).



Once the cable has been threaded through the rack, carefully pull enough cable through to reach the rear light located at the top of the rack.

10



Begin installing the rear rack by snugging the lower mounts of the rack to the mounts found on the rear triangle of the bike.

13

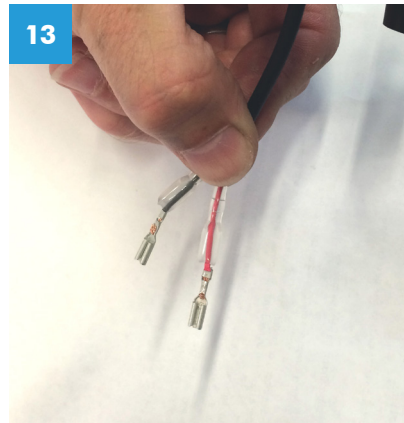

Repeat steps 5 through 8 in part #1 to prep the rear light wires for installation.

11



Choose the correct length struts for the frame size. Placing slight bends in the struts will help them better fit the frame and rack.

Connect the rear rack to the rack mounts on the frame using a strut on both sides. Gently snug each of the allen bolts down. Do not tighten yet because you want to leave room for later adjustment.

14

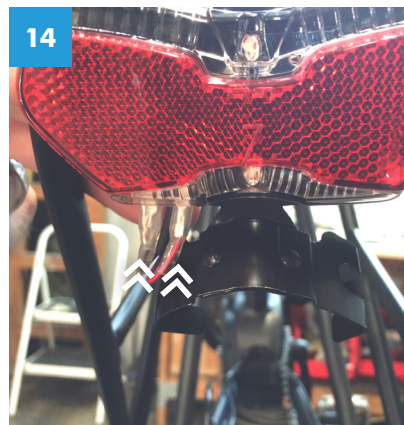

Once the wires have been prepped, plug each of the wires into the rear light and push the silicone covers up and into place.

12



Place the bike on a flat surface and adjust the rear rack to make sure it is parallel with the ground.

Once it is parallel with the ground, finish tightening bolts on the rear struts to secure the rack in place.

15



Wrap the new connections in electrical tape to protect them.

16



Reinstall the kickstand and then place both the front and rear wheel back on the bike.

17



Reinstall the left side of the motor cover by carefully tucking the wires back in and tightening each of the 3 fastening screws.

18



Reinstall the left crank arm.

19



Hold the rear fender loosely in place and gently snug the fastening bolt into the bridge found under the seat stays.

Do not tighten yet because you want to leave room for later adjustment.

20



Gently snug fender to the lower bridge of the frame by locating the hole found on the back side of the motor assembly. You will need to use the supplied spacer to keep the fender the correct distance from the frame and tire.

21

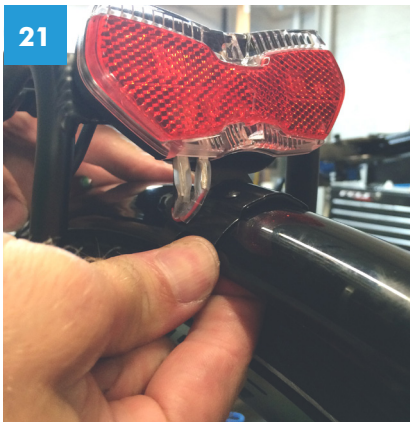

Adjust the fender to rough final position and use your fingers to bend the clamps found below the rear light so that they grip the fender.

Adjust the fender to it's final position and then tighten each of the fastening bolts to lock it in place.

LIGHT SYSTEM ACTIVATION

**PLEASE REFER TO THE BOSCH SYSTEM MANUAL
WHEN ACTIVATING THE LIGHT SYSTEM.**

» CONTACT INFORMATION

Felt Racing, LLC
12 Chrysler
Irvine, CA 92618
USA

Felt GmbH
Industriestr. 39
26188 Edewecht
Germany

WWW.FELTELECTRIC.COM
INFO@FELTELECTRIC.COM

