

EDICT TECHNICAL MANUAL



» INTRODUCTION

EDICT

Congratulations on purchasing a Felt Edict. As with all of our bikes and components, our aim is to provide the rider with the best product and riding experience. Read this manual supplement thoroughly, as it's to help you set your bike up correctly, and care for it.

For further information, visit:
FELTBICYCLES.COM

» CONTENTS

INTRODUCTION

Fast Explained	2-3
Geometry	4

SETUP

Shock Setup	5
Head Tube Cable Guides	6
Bottom Bracket Cable Guides	7

CABLE ROUTING

Rear Brake Cable/Hose Routing	8-9
Rear Shifter Cable Routing	10-11
Dropper Post Cable/Hose Routing	12
Shock Remote Cable Routing	13

MAINTENANCE

Evaluation	14
Pivot Location / Torque Values	15
Main Pivot	16-17
Seat Tube Pivot	18-19
Seat Stay Pivot	20-21

REPLACEMENT PARTS

Master Parts List	22
Hardware Rebuild Kit	23
Bearing Kit	23
Toolkit	24

CONTACT INFORMATION

Contact	25
---------------	----



» FAST EXPLAINED

FAST, or Felt Active Stay Technology, is a linkage-driven, single pivot system with flexible carbon stays. By replacing the pivot near the dropout with flexible carbon stays a lighter, stiffer, and overall snappier frame can be made.

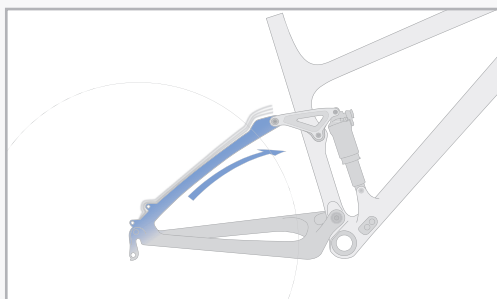

COMPRESSED

0% Travel (Top-Out): In order for the suspension to reach full extension, the rear triangle is required to compress.

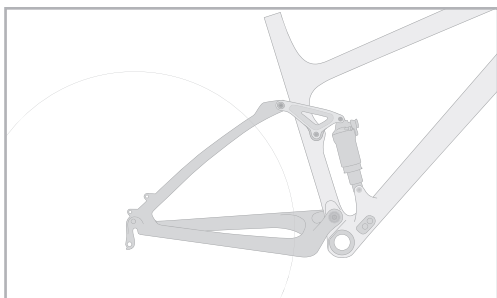

NEUTRAL

30% Travel (Sag): At the sag point (approximately 30%), the rear triangle is neutral.

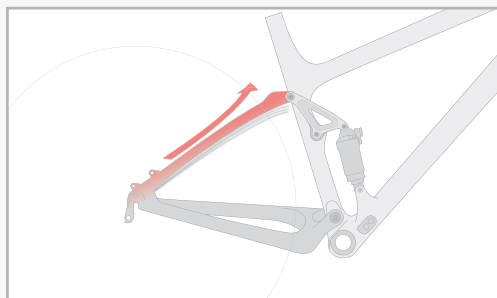

EXTENDED

100% (Bottom-Out): As the suspension gets deeper in the travel, the rear triangle is required to extend.

» FAST EXPLAINED CONT.

Efficient Pedaling: In order to provide efficient pedaling, FAST relies on both ideal anti-squat values as well as the flexible carbon stays. As the suspension moves away from the sag point in either direction, a force is created from either compressing or extending the stays. This force acts on the shock and helps return it back to sag. This provides a stable, responsive platform for pedaling.

Large Impacts: Support for large impacts is provided in two ways: decreasing leverage ratio and carbon flex. The leverage ratio is decreasing which makes it progressively harder to compress the suspension as it moves through the travel. The carbon stays add to this by contributing an additional spring force as they are extended through the travel.

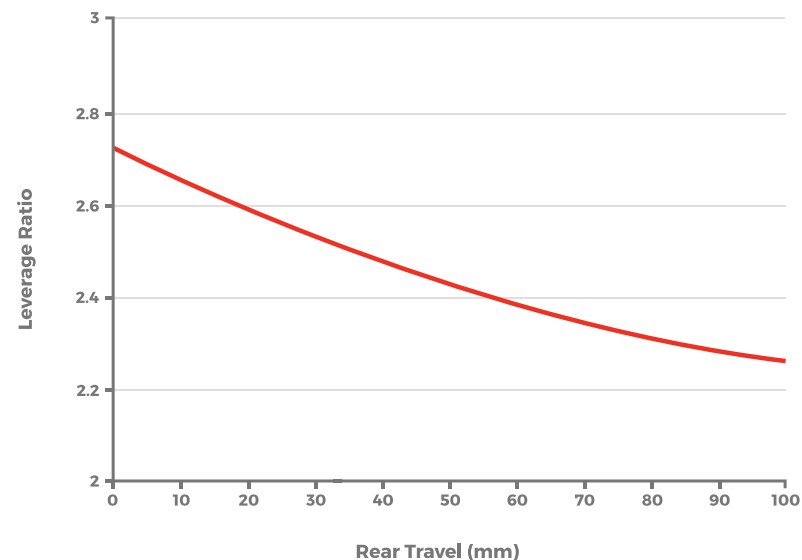

Small-Bump Sensitivity: With the pedaling performance and large impact support handled by the linkage design and flexible carbon stays, the shock can be run with minimal compression damping. This frees the shock up to remain active and absorb the smallest of bumps.

» GEOMETRY

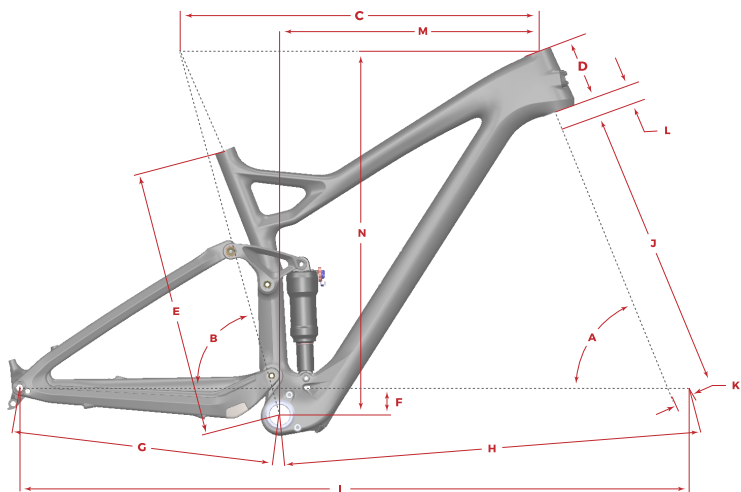

	S (16")	M (18")	L (20")	XL (22")	Size
A	70	70	70	70	Head Tube Angle
B	74.3	74.3	74.3	74.3	Seat Tube Angle
C	573	573	573	573	Top Tube Horizontal
D	90	105	120	145	Head Tube
E	405	450	495	540	Seat Tube
F	45	45	45	45	BB Drop
G	436	436	436	436	Chainstay
H	661	688	715	742	Front Center
I	1093	1121	1148	1175	Wheelbase
J	506	506	506	506	Fork Length
K	51	51	51	51	Rake
L	1	1	1	1	Lower HS Stack
M	407	429	451	470	Reach
N	589	603	617	640	Stack

**EDICT FRD
EDICT 1**
(100mm Fork)

	S (16")	M (18")	L (20")	XL (22")	Size
A	69	69	69	69	Head Tube Angle
B	73.3	73.3	73.3	73.3	Seat Tube Angle
C	576	602	628	653	Top Tube Horizontal
D	90	105	120	145	Head Tube
E	405	450	495	540	Seat Tube
F	38	38	38	38	BB Drop
G	436	436	436	436	Chainstay
H	667	694	721	748	Front Center
I	1101	1128	1155	1182	Wheelbase
J	526	526	526	526	Fork Length
K	51	51	51	51	Rake
L	1	1	1	1	Lower HS Stack
M	397	419	441	459	Reach
N	596	610	624	647	Stack

**EDICT 3
EDICT 4
EDICT 5**
(120mm Fork)

» SHOCK SETUP

It is very important to have the correct amount of sag so that the suspension can be in the part of its travel that is most efficient and compliant. Felt recommends starting at 30% and adding/subtracting up to 5-10% to fine tune to your personal preference.

To measure sag, follow these 4 steps:

1. Push the o-ring to the top of the shock shaft.
2. Sit on the bike with the seat at full ride height to compress the shock. Bounce a few times, then push the o-ring back to the top of the shaft.
3. Gently get off the bike, taking care not to change the position of the o-ring. On some shock models, the sag gradients will be printed on the shaft. In this case, simply read your sag percentage as it is printed on the shock shaft. If there are no sag gradients, measure the distance of the o-ring from the top of the shaft. To achieve 30% sag, the o-ring should be 12mm from the top of the shaft. If there is too much sag (>30%) add air pressure, if there is not enough sag (<30%), reduce air pressure.
4. Repeat process until desired sag is achieved.

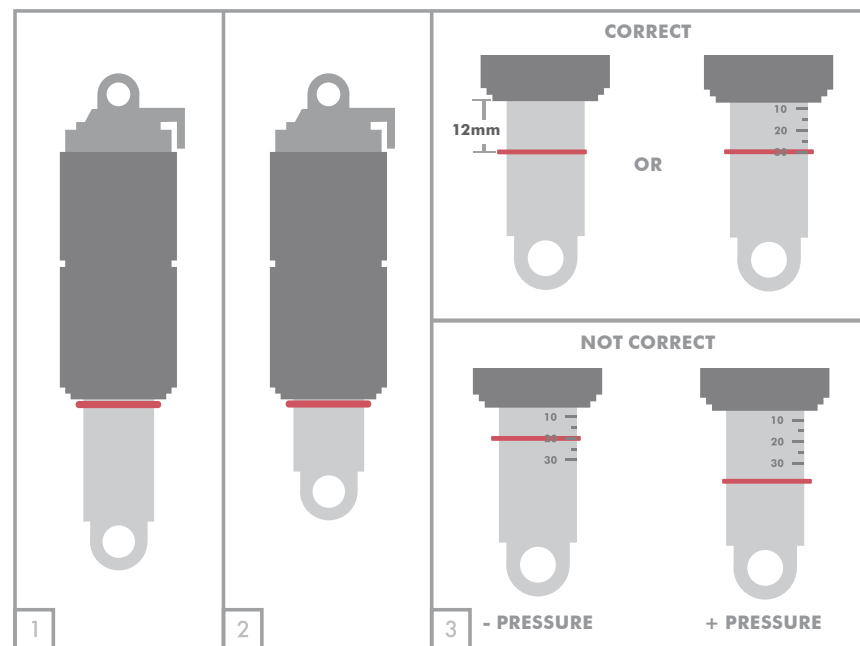

» HEAD TUBE CABLE GUIDES

The head tube cable guides contain rubber reducers for all cable sizes that are interchangeable and can be arranged to fit each rider's setup and personal preferences.

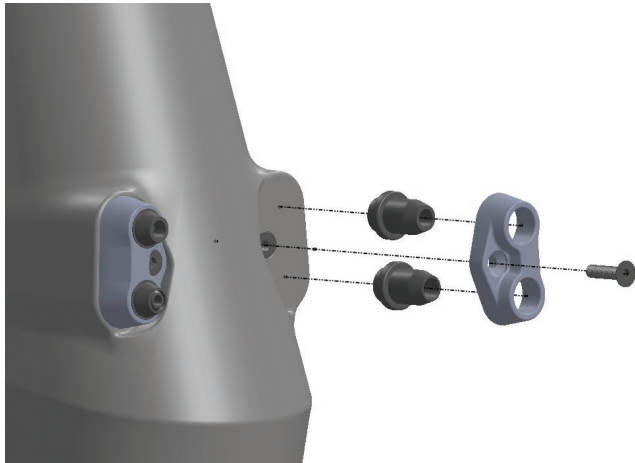

Brake (5mm)



Blank Plug



Di2 (2mm)



Shift (4mm)

» BOTTOM BRACKET CABLE GUIDES

The bottom bracket cable guide can be adapted to different configurations with rubber reducers for different sizes of cables. It can also be used as a battery holder.

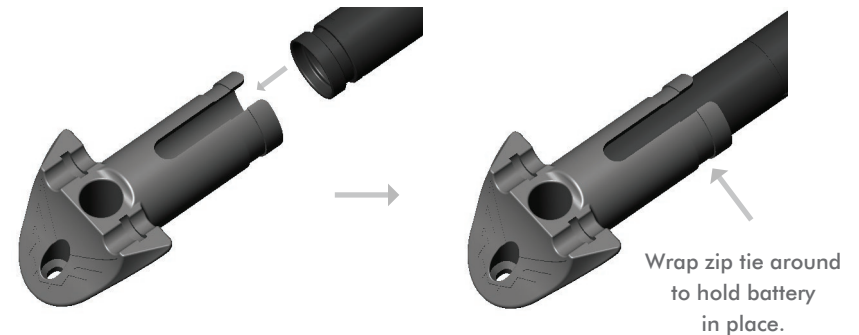

Di2 (2mm)



Shift (4mm)



Brake (5mm)

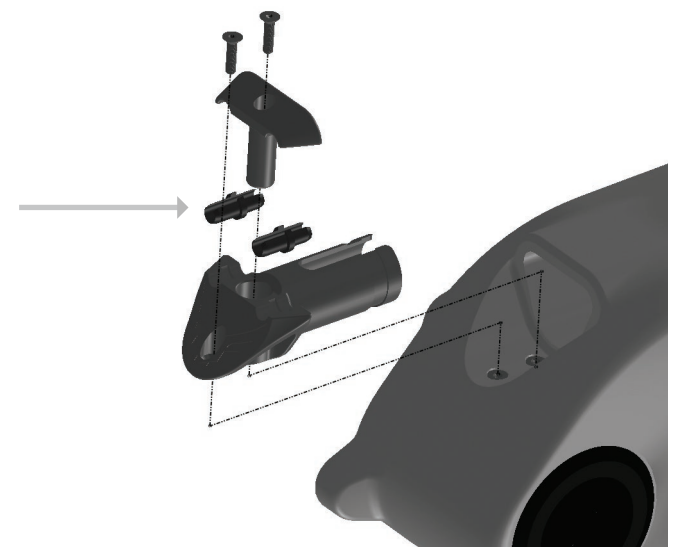

» ROUTING REAR BRAKE

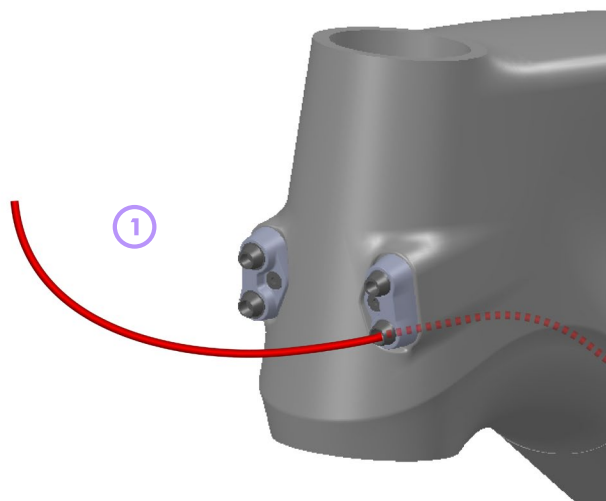
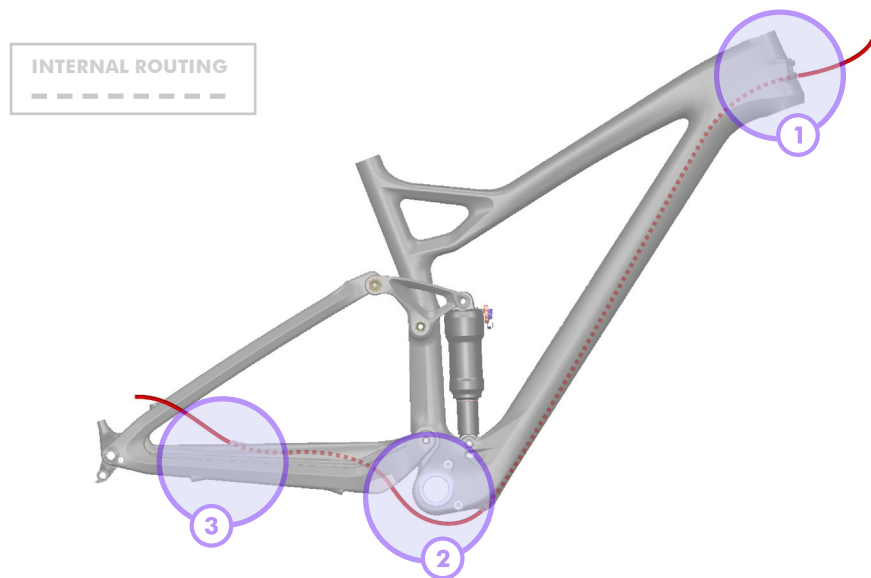

» ROUTING REAR BRAKE CONT.

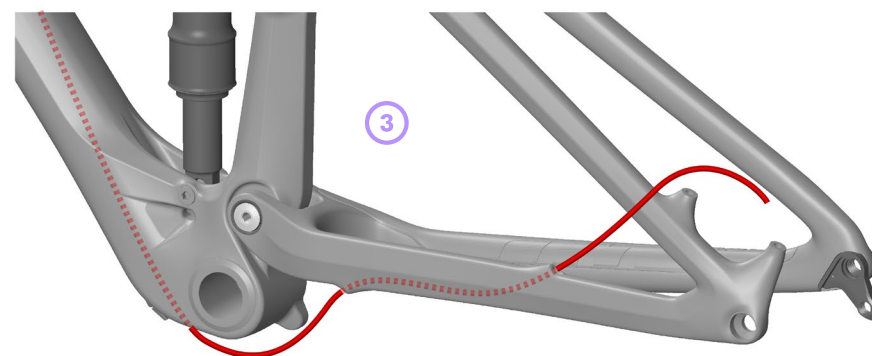
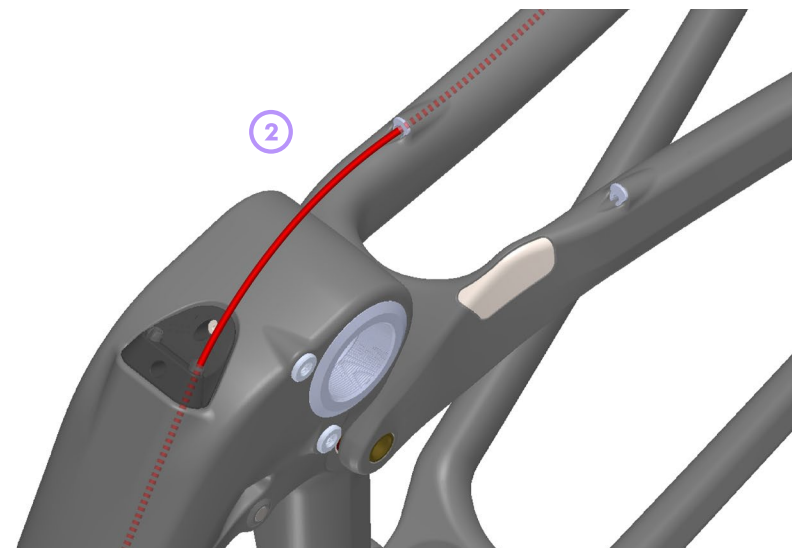

» ROUTING REAR SHIFTER

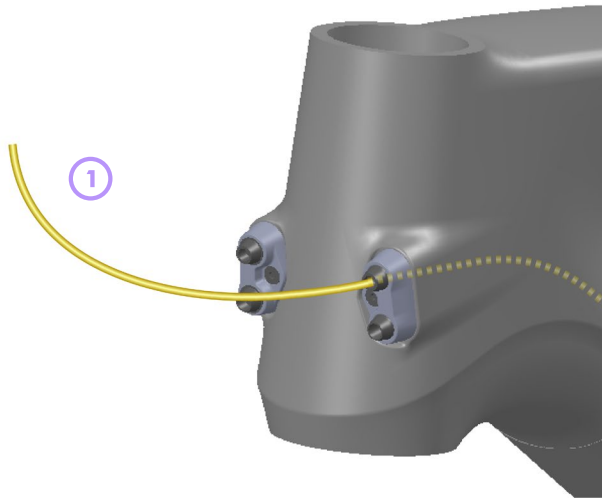
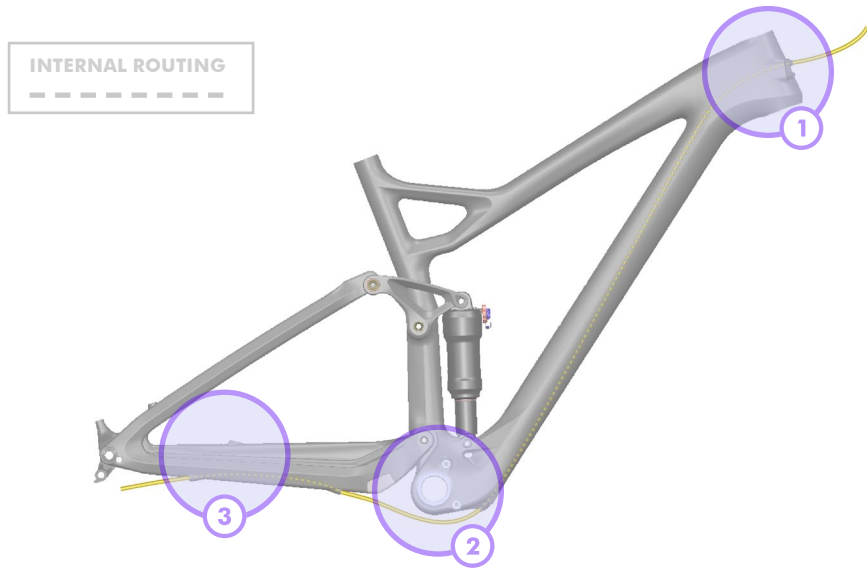

» ROUTING REAR SHIFTER CONT.

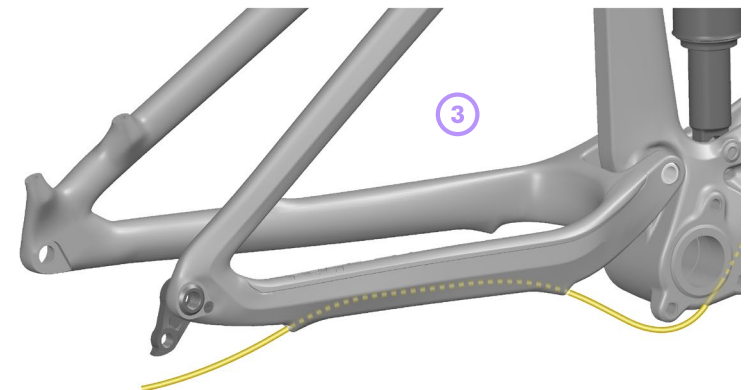
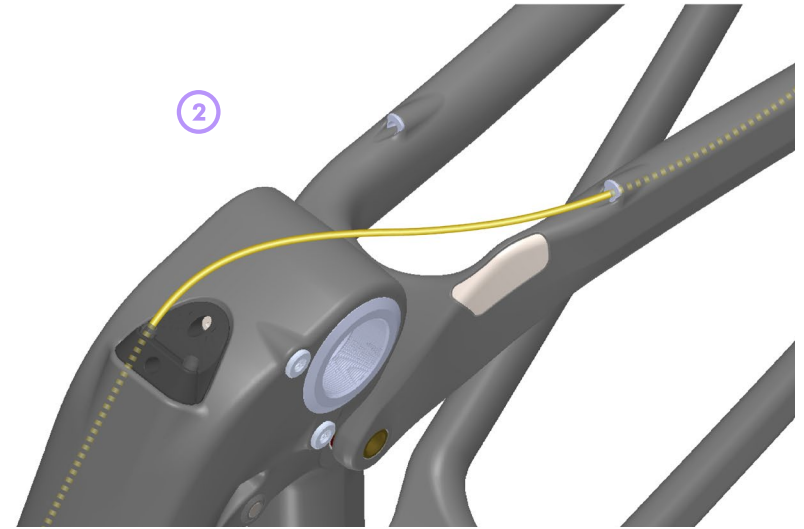

» ROUTING DROPPER POST

INTERNAL ROUTING

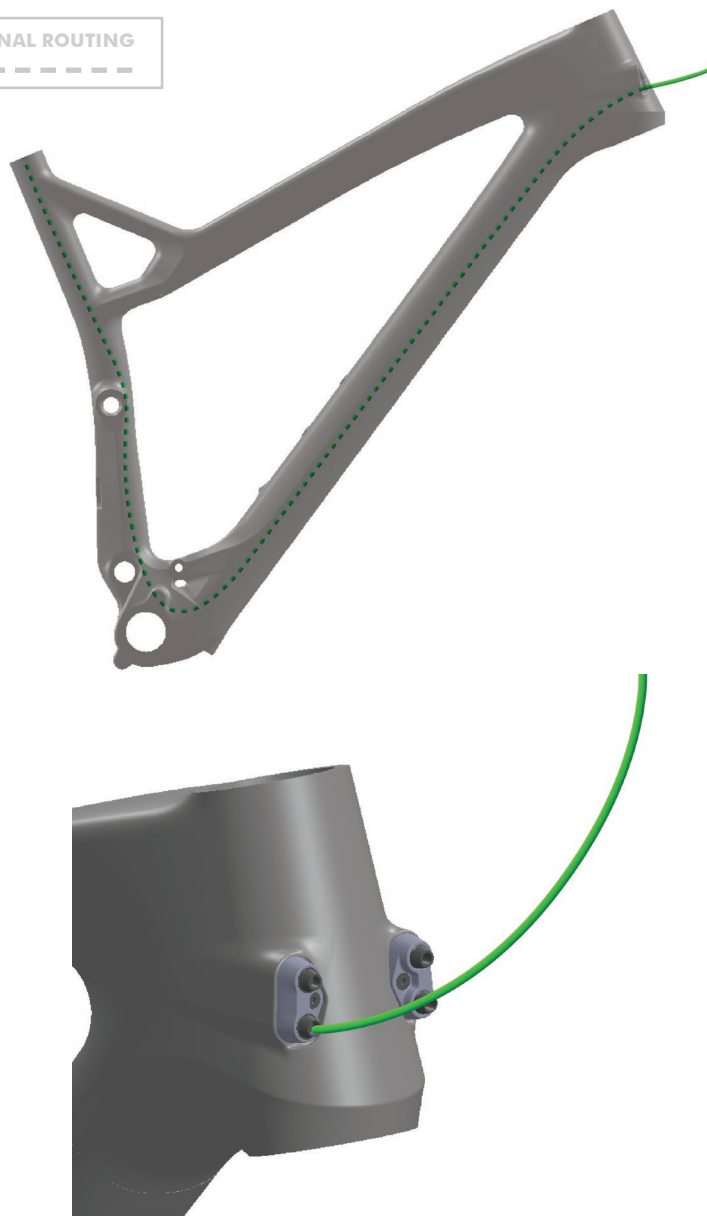

» ROUTING SHOCK REMOTE

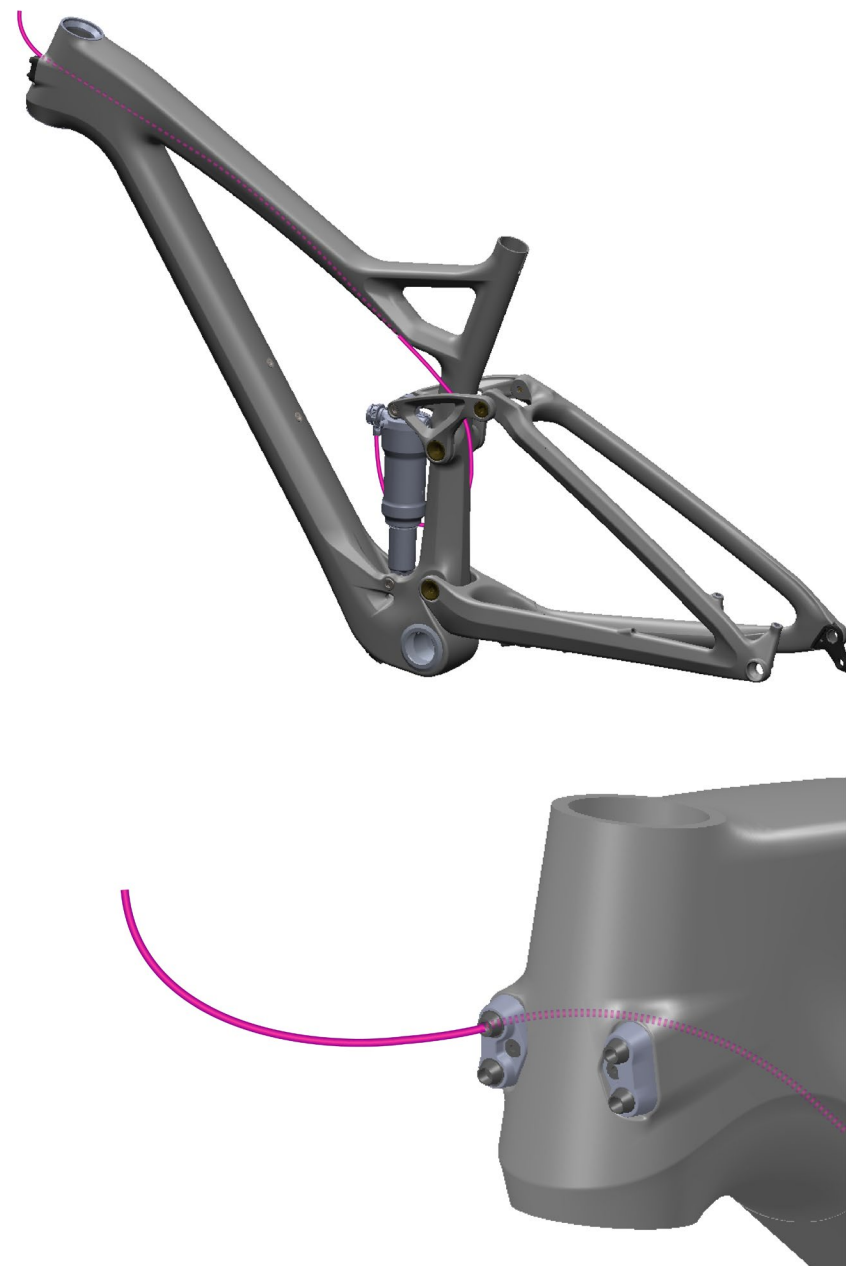

» EVALUATION

In order to achieve optimum suspension performance, Felt recommends performing a simple pivot checking procedure after every 100 hours of riding or annually, whichever comes first. If any issues are discovered, please refer to the bearing removal/installation section or take your bike to the nearest Felt dealer.

Pivot Checking Procedure

1. Check torque on all pivot bolts. If bolts are loose, remove, clean and apply Loctite 242 to the threads, then tighten to correct torque (see technical section for torque values).
2. With the shock installed, apply pressure vertically and horizontally to feel for any play in the pivots. If play is discovered, please refer to the technical section for more information and instructions for bearing removal/installation.

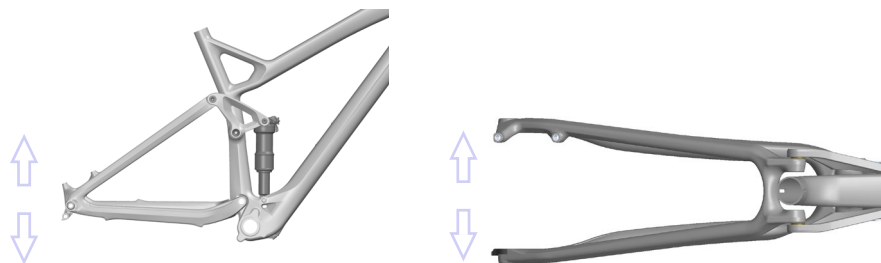

3. With the shock removed, move the suspension through its travel. There should be little to no friction. If there is any friction, please refer to the technical section for more information and instructions for bearing removal/installation.

Move Rear Triangle through travel.

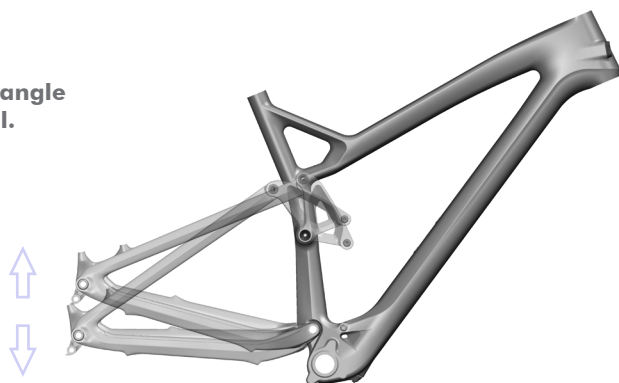

» PIVOT LOCATION

Seat Stay Pivot	15N-m
Seat Tube Pivot	18N-m
Main Pivot	18N-m
Shock Mounts	15N-m

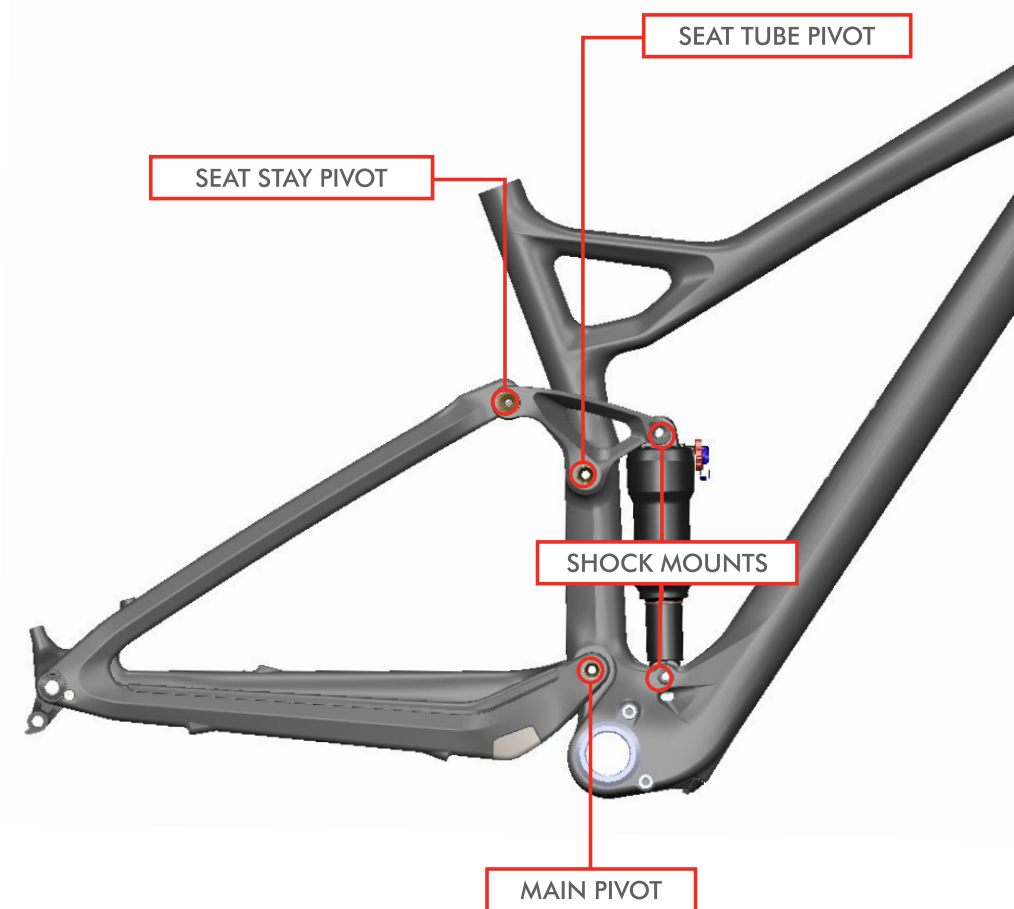

» MAIN PIVOT

EXPLODED

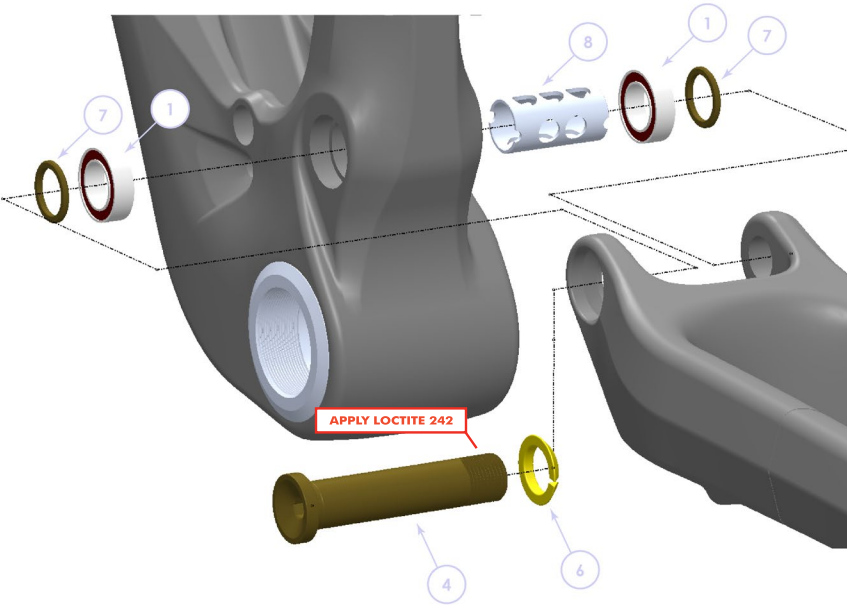

item no.	description	qty.
1	3802 LLB Max Bearing	2
4	Main Pivot Axle	1
6	Collet Cone	1
7	Main Pivot Spacer	2
8	Main Pivot Bearing Support	1

» MAIN PIVOT CONT.

BEARING REMOVAL

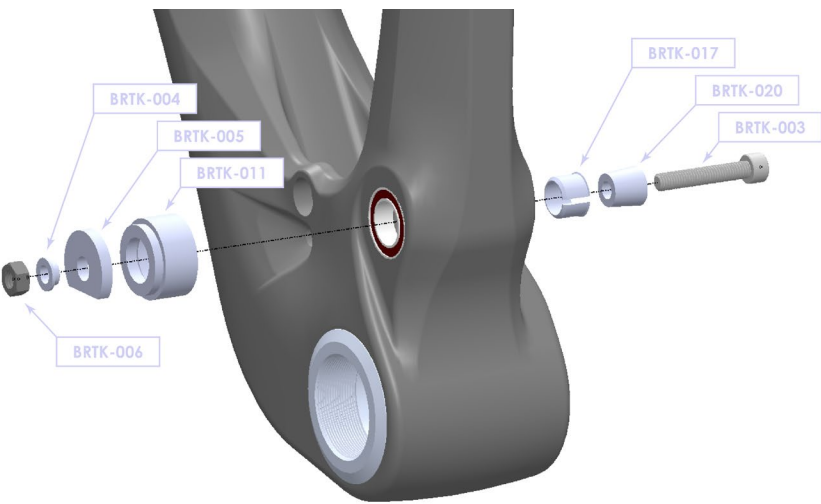

BEARING INSTALLATION

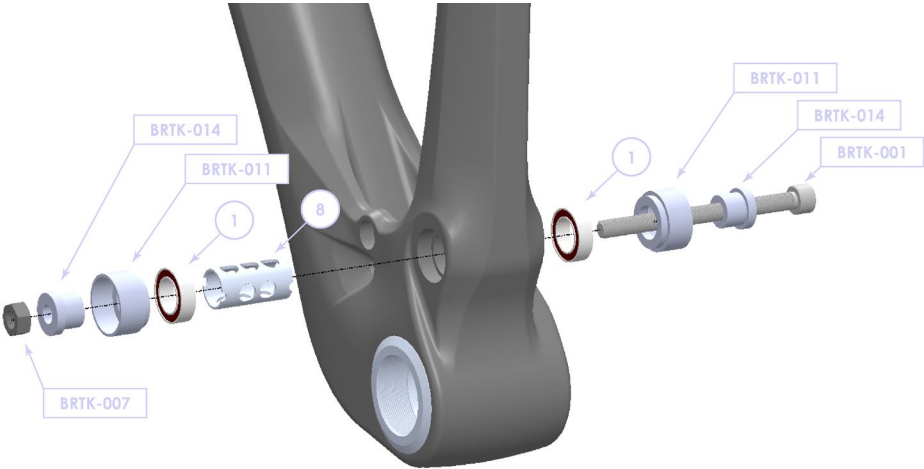

» SEAT TUBE PIVOT

EXPLODED

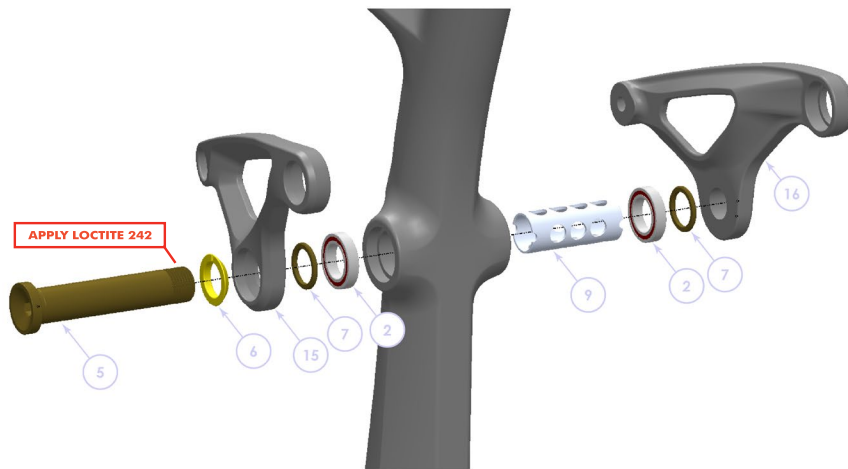

item no.	description	qty.
2	6802 LLB Max	2
5	Upper Pivot Axle	1
6	Collet Cone	1
7	Main Pivot Spacer	2
9	Upper Pivot Bearing Support	1
15	Rocker Link - Left	1
16	Rocker Link - Right	1

» SEAT TUBE PIVOT^{CONT.}

BEARING REMOVAL

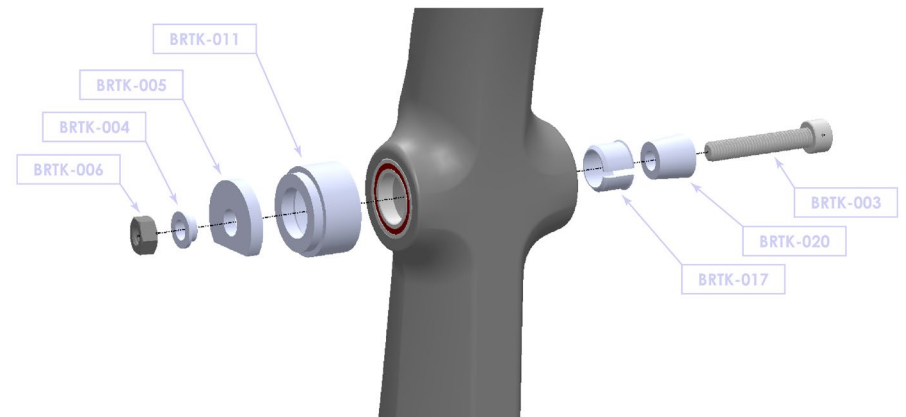

BEARING INSTALLATION

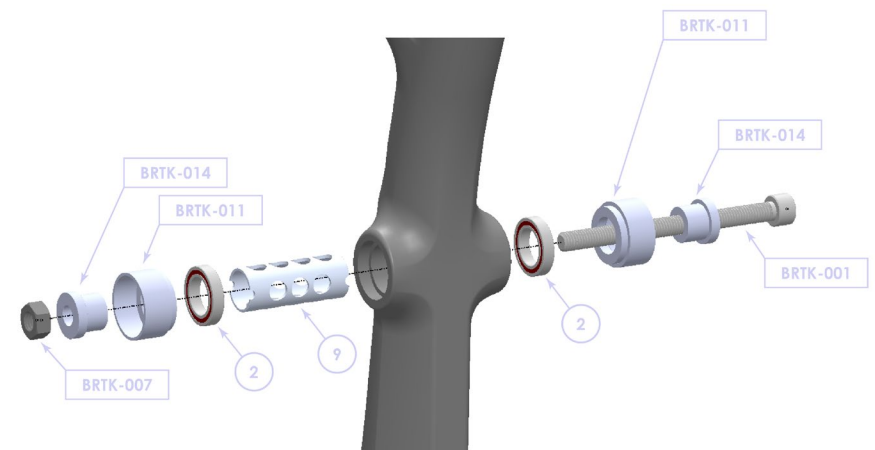

» SEAT STAY PIVOT

EXPLODED

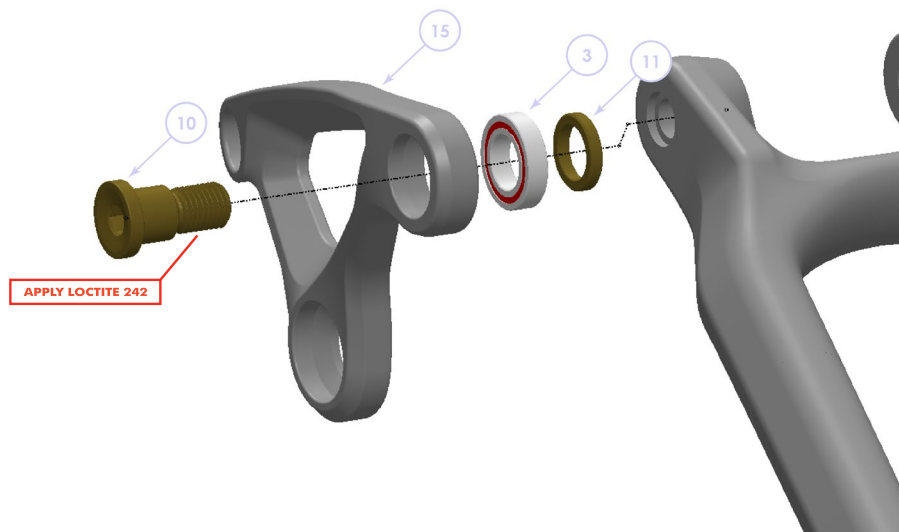

item no.	description	qty.
3	6801 LLB Max	1
10	Seatstay Yoke Pivot Screw	1
11	Seatstay Yoke Pivot Spacer	1
15	Rocker Link - Left	1

» SEAT STAY PIVOT CONT.

BEARING REMOVAL

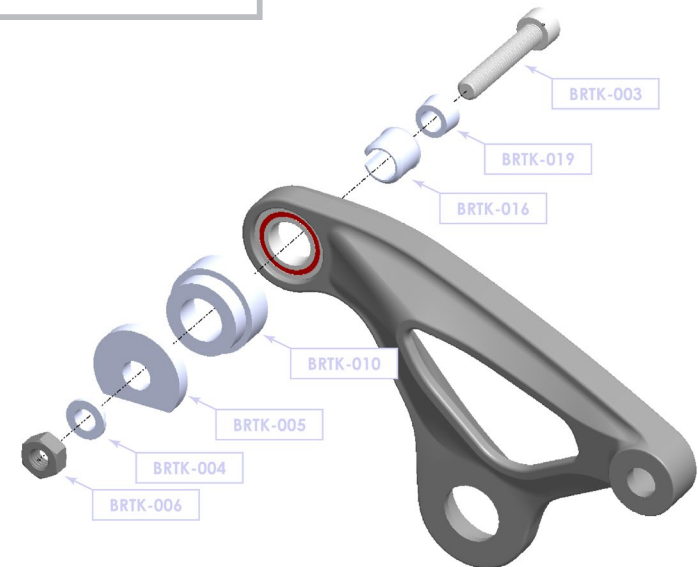

BEARING INSTALLATION

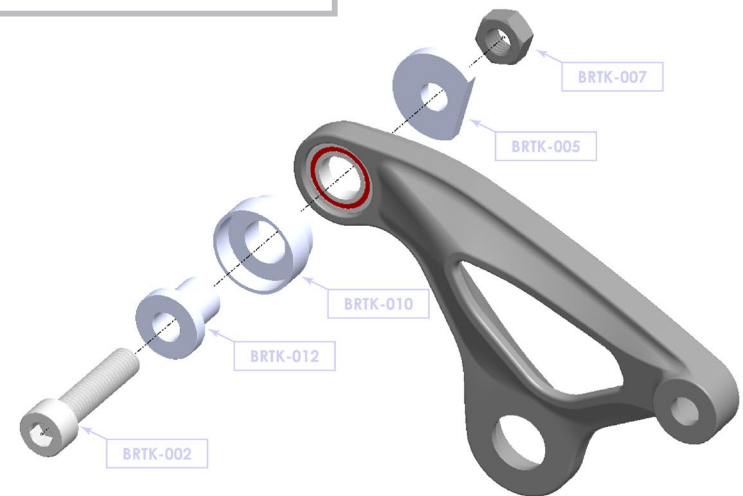

MASTER PARTS LIST: DECREE

item no.	description	qty.
1	3802 LLB Max Bearing	2
2	6802 LLB Max Bearing	2
3	6801 LLB Max Bearing	2
4	Main Pivot Axle	1
5	Upper Pivot Axle	1
6	Collet Cone	2
7	Main Pivot Spacer	4
8	Main Pivot Bearing Support	1
9	Upper Pivot Bearing Support	1
10	Seatstay Yoke Pivot Screw	2
11	Seatstay Yoke Pivot Spacer	2
12	Upper Shock Bolt	1
13	Shock Bolt Collet	1
14	Lower Shock Bolt	1
15	Rocker Link - Left	1
16	Rocker Link - Right	1

****Felt offers a bearing rebuild kit as well as a complete hardware rebuild kit. There is also a tool kit for proper removal and installation of the bearings. Individual parts may also be ordered. Contact your local dealer for more information.**

» HARDWARE REBUILD KIT

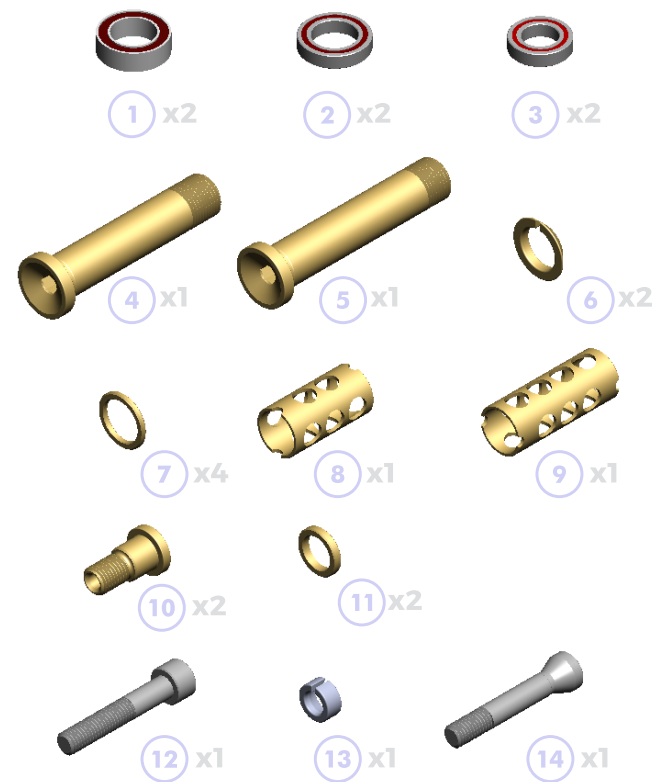

» BEARING KIT



» TOOLKIT

sku#964926



BRTK-001



BRTK-002



BRTK-003



BRTK-004



BRTK-005



BRTK-006



BRTK-007



BRTK-008



BRTK-009



BRTK-010

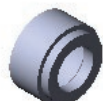

BRTK-011



BRTK-012



BRTK-013



BRTK-014



BRTK-015



BRTK-016



BRTK-017



BRTK-018



BRTK-019



BRTK-020

» CONTACT INFORMATION

Felt Racing, LLC
12 Chrysler
Irvine, CA 92618
USA

Felt GmbH
Industriestr. 39
26188 Edewecht
Germany

WWW.FELTBICYCLES.COM

